

Salire® 100-SG

Roller system with side guide

Key Features :

- 4:1 ratio chain mechanism for easy operation on large blind sizes
- The zipper channel/side guide stabilizes the roller blind
- Built in auto stop mechanism for upper and lower limit setting
- Robust anti-deflection 47 mm diameter tube
- Aesthetic end caps
- Aesthetic aluminum fascia available as an option
- Face, top or wall fixing options

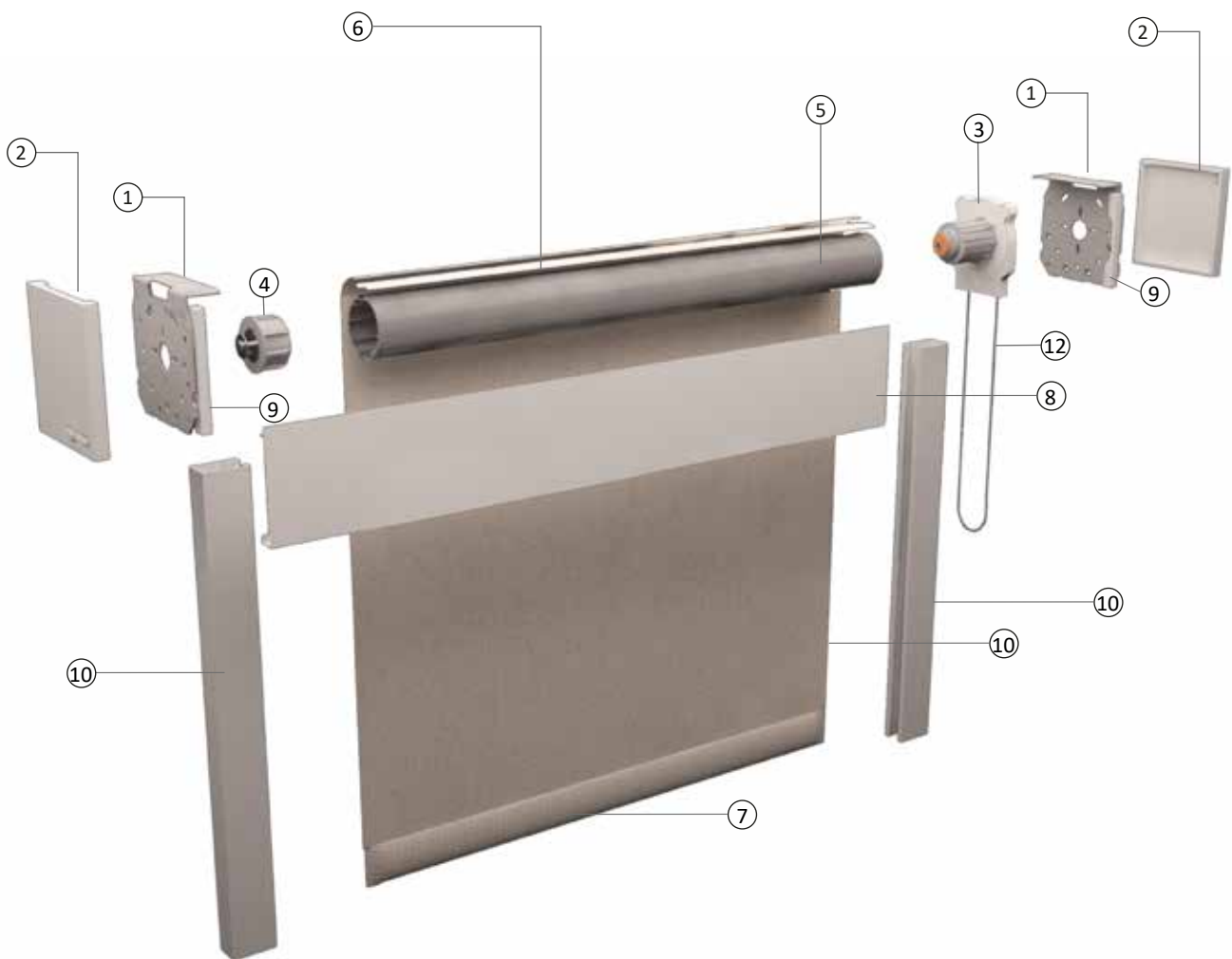

1. Mounting brackets
2. Bracket cover
3. Operating clutch

4. End plug
5. Tube
6. Mounting spline

7. Hem bar
8. Optional fascia
9. Fascia support

10. Fabric
11. Side guide
12. Ball chain