

Salire® 100-ZC

Roller system with zipper channel

Key Features :

- Room darkening or AV system
- The zipper channel stabilizes the roller blind
- Built in auto stop mechanism for upper and lower limit setting
- Robust anti-deflection 47 mm diameter tube
- Aesthetic end caps
- Aesthetic aluminum fascia available as an option
- Face, top or wall fixing options
- Additional weighting by steel profile is possible (Only with exposed bottom bar)

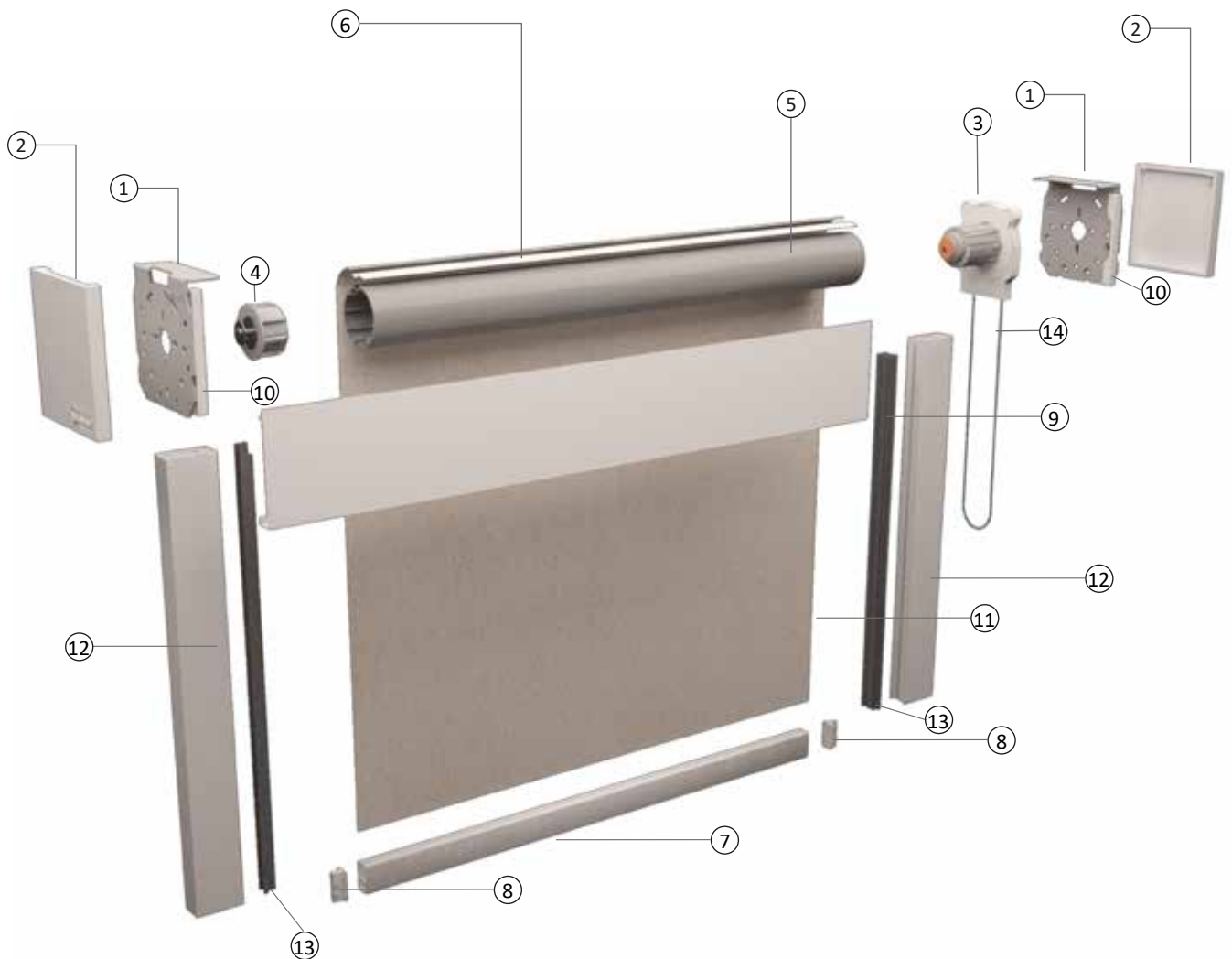

1. Mounting brackets
2. Bracket cover
3. Operating clutch
4. End plug

5. Tube
6. Mounting spline
7. Hem bar
8. End cap hem bar

9. Optional fascia
10. Fascia support
11. Fabric
12. Zipper channel

13. Zipper
14. Ball chain